

**Maintenance**

1. Wipe the surface of the equipment with a slightly damp towel and dry it with a soft cloth.
2. When storing or travelling for a long time, please separate the battery from the equipment and put it in the original packing box of the equipment.

**Warning**

1. Don't immerse in water, keep away from liquid and heat source at the same time, and keep the motor cooling hole free of dust and sundries.
2. Do not disassemble screws without permission.
3. Shut down the equipment for half an hour for every hour of operation.
4. Unplug the charger from the battery after charging or before use, and do not use it during charging.
5. Use of this equipment is prohibited without consulting a doctor for the injured part of the body.

**Disclaimer**

Before using the equipment, please read the operating instructions carefully, then use this equipment correctly according to the instructions. The company will not assume any legal obligations for the injuries and losses caused by the improper use of the equipment according to the instructions. Do not use in high speed and high pressure or prohibit the use of equipment without the doctor's approval in any of the following circumstances:

Pregnancy, diabetes, neuropathy or retinal damage, pacemaker wear, recent surgery, epilepsy or migraine, disc herniation, lysis or spondylitis, recent joint replacement or intrauterine device or physical health problems, weak adults and children (need to be accompanied by healthy adults). These contradictions do not mean that you cannot use this equipment. We suggest you consult your doctor before using it with his permission. We are studying the impact of the equipment on specific medical diseases, which may lead to the above description not being comprehensive and detailed, but all people suffering from the above symptoms must be completed with the advice and accompanied by the doctors, experts or physiotherapists.



**User Manual**

**Physiotherapy Apparatus  
for Myofascium  
CC - 9111**

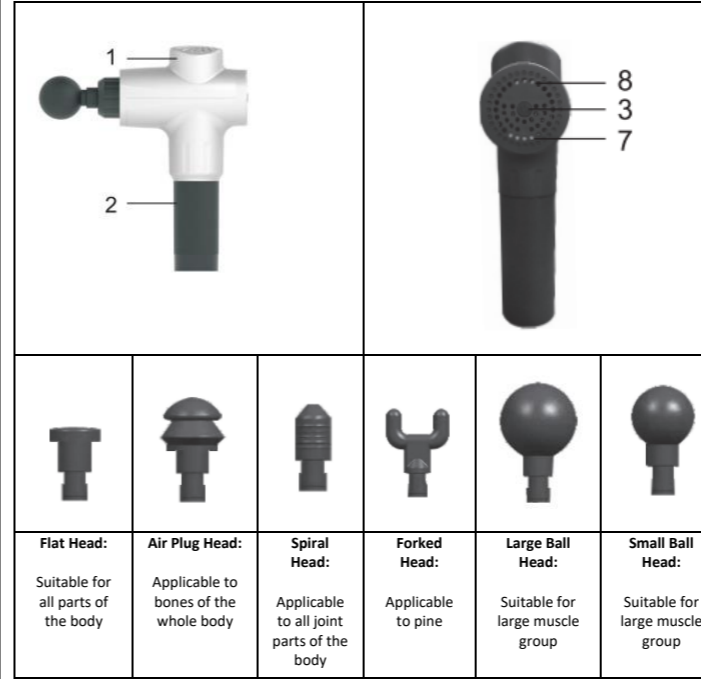

1. High frequency, high silence, high speed motor
2. Battery
3. Start and speed control button for motor
4. Battery switch +
5. Charging jack
6. 6 kinds of massage heads;
7. Electricity indicator lamp (when four green lights and one red light are from the left, it indicates sufficient battery.
  - a. Then as the usage time gets longer and longer, the four green lights will turn off from left to right, and finally only on the red light is on, indicating that the electricity is exhausted and needs to be charged).
8. Gear indicator light (the first blue light from the right lights up as first gear (pulse frequency: 4 1800 rpm), the second gear when two blue lights light up (pulse frequency: 2400 rpm), and the third when three lights light up (pulse frequency: 3200 rpm: 5 minutes)



**Instructions for use**

1. When the battery switch 6 is turned to the "ON" position, both the battery power on indicator and the power supply power indicator 9 will be on, with 4 green lights and 1 red light representing the power consumption from strong to weak from left to right, and when only the red light is on, it means that the power consumption needs to be charged.
2. According to the different needs of massage parts, specific heads are selected to be inserted into the round hole in front of the fascia gun.

3. When the motor start button 4 is pressed, the motor will start to rotate; The first green light above the motor button lights up to represent gear "1"; Press the motor start button again, the two green lights illuminate to gear 2; Press the motor start button three times and the three green lights light up to represent gear 3"; Press the motor start button four times, then the motor stops rotating; Press the motor again to start "1" gear. The above is the basic cycle flow.
4. Turn off the battery switch after massage.
5. In order to protect equipment, the connection will automatically stop protection after 10 minutes of continuous operation. If it is still needed, please turn it on again.

**Battery Instructions**

1. After the power is exhausted, the battery needs to be charged for 2.5-3 hours to be fully charged, and the duration of battery life depends on the gear adjustment. When the battery is charged, the battery power indicator lamp 5 will light up, which means that the charging is normal. At the same time, it is forbidden to start the motor when charging. For your safety, the motor key cannot be started when charging the battery.

**Safety Instructions**

To reduce electric shock, fire and personal injury, this product must be used according to the following instructions.

1. Only for adults.
2. This equipment cannot directly massage the skin surface, so as not to cause damage to the skin. The massage part or the equipment should be covered with dry and clean clothes, and the equipment should be gently pressed and moved during use. The massage time for the same part should not exceed 60 seconds.
3. Under the condition of no pain, tumor and discomfort, only the soft tissue parts of the body can be used with high speed and pressure, and the head and any bone parts of the body cannot be used with high speed and pressure.
4. According to the massage needs of different parts, please select the appropriate massage head.
5. Frequent high-speed and high-pressure on the same part will cause bruises, accompanied by pain and discomfort, which should be stopped immediately.
6. Please keep your fingers and all your hair away from the telescopic rod of the equipment and the cooling hole of the motor on the back to prevent pinching.
7. Do not put any objects into the heat dissipation holes of the motor.
8. Do not overflow the equipment into the water. No water is allowed to enter the equipment from the heat dissipation hole of the motor. Do not discard or misuse this equipment.
9. Do not discard or misuse this equipment.
10. Only the charger provided by the original factory can be used for charging.
11. Please check the equipment and battery carefully before each use.
12. Don't make any modifications to the equipment without permission.
13. Do not operate the equipment and charge the equipment in unattended condition.

